

What was the No1 fear everyone had about a new school?

FACE THE BIG
FEAR

MUM100



Springwood High School



Springwood High School
Plan of School

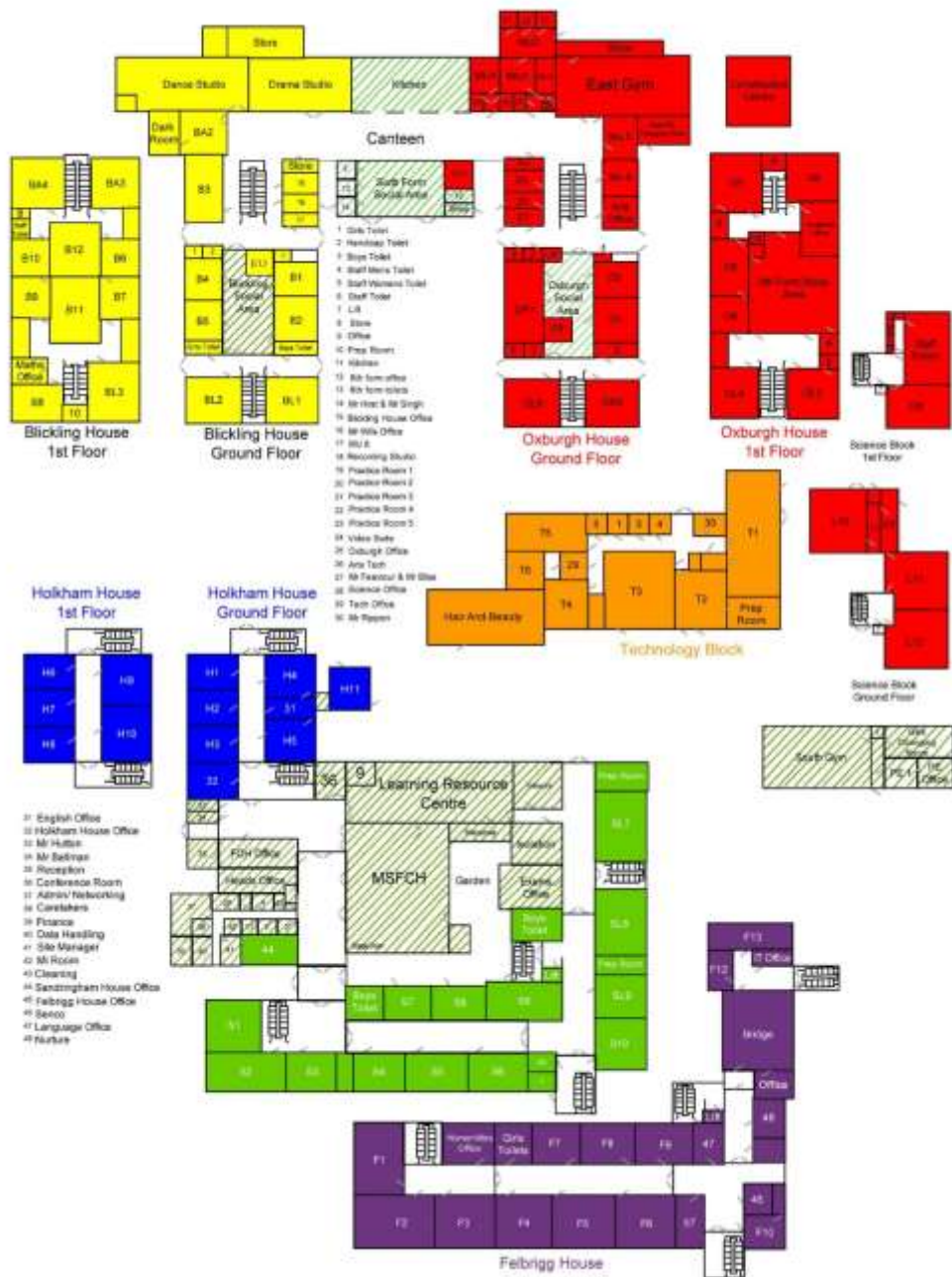

Using your school map...



This is what you will see on your timetable. Can you make sense of it?

	1Mon		1Tue	
Pre				
Tut	7B2	Pc	7B2	Pc
	NHT	BL3	NHT	BL3
1	7S/En4	En	7cd/Pe1	Pe
	MI	H1	SU	South Gym
2	7CD1/Sc	Sc	7B2/Hi	Hi
	AMS	L11	SWS	S7
Bre				
3	7B2/G	G	7B2/Re	Re
	RH	S6	ASR	S8
Lun				
4	7CD1/Sc	Sc	7CD1/D	D
	CAB	SL7	CU	F9
5	7B2/Re	Re	7S/En4	En
	ASR	S8	MI	H1
Tw				

- Look at Tutor time for Monday
- (top left)
- 7B2 is the name of the class
- Pc is the code for tutor time
- NHT is the teacher
- BL3 is the room

See if you can read this one!

	1Mon	1Tue	as
Pre			
Tut	7B2 Pc NHT BL3	7B2 Pc NHT BL3	
1	7S/En4 En MI H1	7cd/Pe1 Pe SU South Gym	
2	7CD1/Sc Sc AMS L11	7B2/Hi Hi SWS S7	
Bre			
3	7B2/G G RH S6	7B2/Re Re ASR S8	
Lun			
4	7CD1/Sc Sc CAB SL7	7CD1/D D CU F9	
5	7B2/Re Re ASR S8	7S/En4 En MI H1	
Twi			

- What subject does this student have for lesson 1?
- What room is Geography in?
- What lesson is RE on Monday?
- What room do you go to after lunch on Monday?
- Where does the teacher with the initials RH teach?

And this one.....

	1Mon		1Tue		as
Pre					
Tut	7B2 NHT	Pc BL3	7B2 NHT	Pc BL3	
1	7S/En4 MI	En H1	7cd/Pe1 SU	Pe South Gym	
2	7CD1/Sc AMS	Sc L11	7B2/Hi SWS	Hi S7	
Bre					
3	7B2/G RH	G S6	7B2/Re ASR	Re S8	
Lun					
4	7CD1/Sc CAB	Sc SL7	7CD1/D CU	D F9	
5	7B2/Re ASR	Re S8	7S/En4 MI	En H1	
Twi					

- Do you need your PE kit on Tuesday?
- You have History on Tuesday. Where?
- You have German on Tuesday. When? (Difficult question!!)
- Which subjects do you have on both days?
- You are taught in your tutor group for RE, Geography and....

FACE THE BIG
FEAR

MUM100

BE
HAPPY

